



# Air Venturi

The Power of Air

## Air Venturi G4 Hand Pump Instruction Manual

AirVenturi.com  
5135 Naiman Parkway  
Solon, OH 44139  
216-292-2570 • fax 216-373-0086  
Copyright ©2014 • Version 01/30/14

### 1-Year Limited Warranty

The Air Venturi G4 hand pump has a one-year limited warranty against manufacturing defects. Failure to properly maintain the pump, abuse or misuse voids the warranty. Repairs done by anyone other than Air Venturi voids the warranty.

### ASSEMBLY STEPS

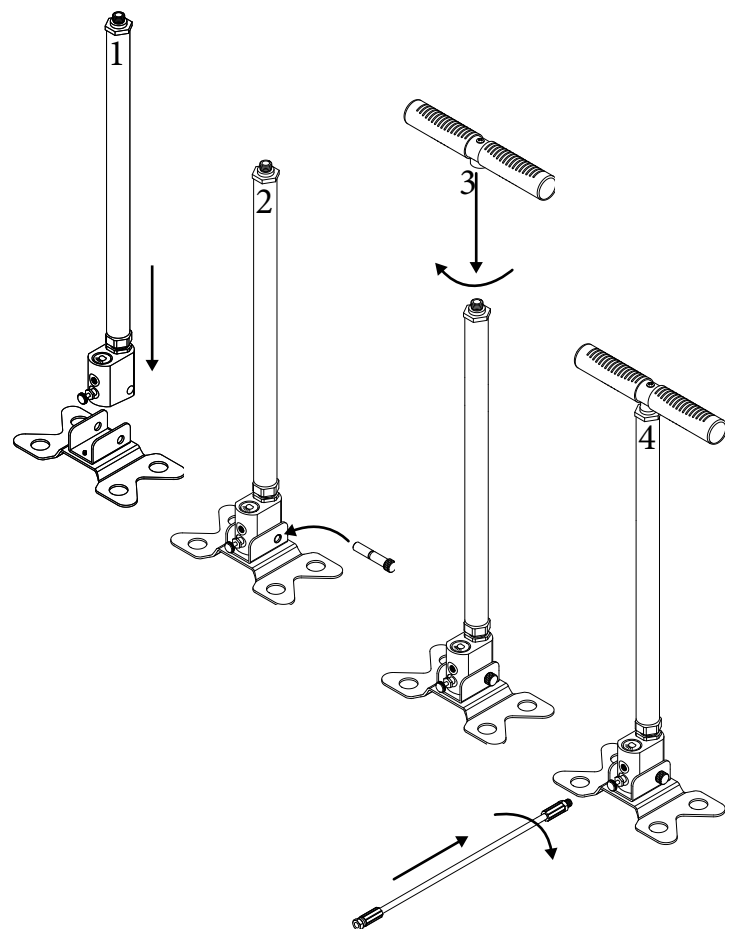

### Please read this instruction manual carefully before using your hand pump!

Thank you for buying the Air Venturi G4 hand pump. Hand pumps are the most convenient and affordable way to charge your PCP air rifle. There are several features that make it easy to use and lengthen the life of the pump.

- Maximum 200 bar fill pressure.
- Ergonomically designed handle with synthetic cover.
- Built-in moisture trap & a built-in particle filter embedded in one side of the handle; the filter traps the moisture and protects your pump & air rifle.
- A compartment in the other side of the handle for spare parts.
- Precise, built-in pressure gauge (manometer) in the frame to protect it from impact.
- Quick-disconnect & tube locking that makes it easier to transport the pump.
- Wide footplate with adjustable pumping angle.
- Includes hose & 1/8 BSPP adapter.

### ASSEMBLY

Assemble your hand pump as shown in "Assembly Steps" picture at left. Don't use tools to tighten the handle. Finger tightness is sufficient.

### USE OF THE PUMP

1. Attach the pump adapter to your gun's air fill port. Make sure the moisture bleed valve is tightened.
2. Grab the handle with your hands and place your feet on the pump's footplate.
3. Pump slowly by lifting up and then pressing down the handle. Continue pumping until you reach your desired pressure level in your gun's air reservoir.
4. When you're done pumping, quickly loosen the moisture bleed valve of the pump so the moisture-filled air trapped in the hose is rapidly discharged. Disconnect the hose from your gun's air reservoir.

### WARNINGS & MAINTENANCE

1. Use this pump to fill a PCP air rifle only. Do not use it for other purposes. For best results, use the pump in low humidity.
2. Pump no longer than 5 minutes (approximately 50 pump strokes). Ever 5 minutes, let the pump cool down for 15 minutes. After each pumping session, exhaust the heat and moisture through the pump's air bleed valve. Most PCPs can be filled within 5 minutes. Cooling the pump after every 50 strokes or when the pump rod is very hot will lengthen the life of the pump's seals and o-rings.
3. Pump slowly and deliberately. Stop for 1-2 seconds at the top and bottom of each stroke. The pump fills the air reservoir with each stroke, whether up or down, though it feels hardest on the down stroke—but make the upstroke count, too. Remember to go all the way to the end of each stroke, as most of the work is accomplished in the last inch or so of pump rod travel.
4. Use your body weight when it becomes harder to pump. After 100 bar, the pumping pressure will steadily increase. Using your body weight gives you more leverage and makes it easier to pump.
5. The pump may become harder to operate after prolonged use. This can be due to lack of lubrication or due to previous lubrication causing the seals and rod

to adhere to each other. Regularly cleaning and lubricating your pump will keep it in optimum working condition and lengthen its life. Lightly lubricate the pump rod (Part #48) and then pump it a few strokes. **Use only diver's silicone grease as a lubricant. Any other type of lubricant, oil or grease, (including petroleum-based ones) should never be used.**

6. Quickly exhaust the pump's air bleed valve before you disconnect your PCP gun. Otherwise, the air fill port of your gun's seals and o-rings may be damaged.
7. The recommended maximum pressure of this pump is 200 bar. **Do not exceed the manufacturer's recommended maximum fill pressure of your gun's air reservoir.** It may cause a dangerous situation resulting in serious injury to you and others if an air reservoir is filled above the recommended maximum pressure level. Also, never fill any air reservoir that is not in good condition or may be damaged.
8. Always use the pump on firm, non-slip surfaces. Assume the appropriate position and posture for pumping.

03/05/13

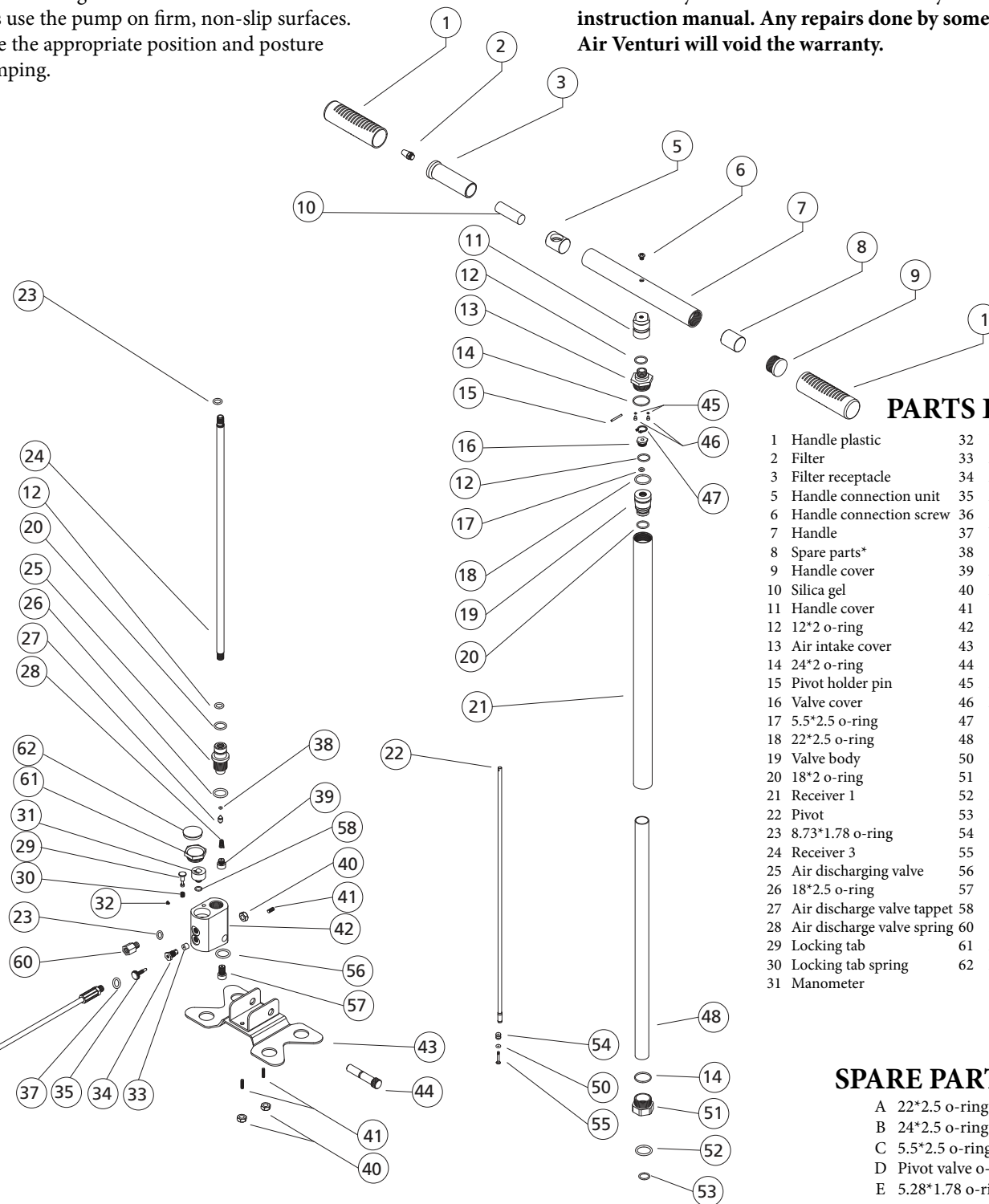

### PARTS LIST

1 Handle plastic	32 Locking tab screw
2 Filter	33 Air bleed plastic
3 Filter receptacle	34 Air bleed nut
5 Handle connection unit	35 Air bleed screw
6 Handle connection screw	36 Flexible hose
7 Handle	37 Washer with plastic
8 Spare parts*	38 5.28*7.78 o-ring
9 Handle cover	39 Air discharge valve cover
10 Silica gel	40 M8 nut
11 Handle cover	41 Ball screw
12 12*2 o-ring	42 Body
13 Air intake cover	43 Stays
14 24*2 o-ring	44 Stays pin
15 Pivot holder pin	45 2.5*1.5 o-ring
16 Valve cover	46 Air intake tappet
17 5.5*2.5 o-ring	47 Clip
18 22*2.5 o-ring	48 Receiver 2
19 Valve body	50 Pivot valve o-fing
20 18*2 o-ring	51 Receiver sub-cover
21 Receiver 1	52 24*2.5 o-ring
22 Pivot	53 21*2.0 o-ring
23 8.73*1.78 o-ring	54 O-ring bushing
24 Receiver 3	55 Bushing holder
25 Air discharging valve	56 10*3 o-ring
26 18*2.5 o-ring	57 Cover
27 Air discharge valve tappet	58 12*3 o-ring
28 Air discharge valve spring	60 Hose connecting unit
29 Locking tab	61 Manometer safety
30 Locking tab spring	62 Manometer cover
31 Manometer	

### SPARE PARTS SET\*

- A 22\*2.5 o-ring (18)
- B 24\*2.5 o-ring (52)
- C 5.5\*2.5 o-ring (17)
- D Pivot valve o-ring (50)
- E 5.28\*1.78 o-ring (38)