



HATSAN
ARMS COMPANY



HATSAN JET Series

PCP AIR PISTOL/RIFLE

**INSTRUCTION
MANUAL**

PLEASE READ THIS MANUAL BEFORE USING YOUR AIRGUN

Thank you for choosing the HATSAN JET air pistol/rifle.

Always use caution when operating this airgun. Learn and obey the laws of your country, state, and/or locale, and be responsible in your use of this airgun. Please read this manual completely before handling or shooting your airgun. It's the sole responsibility of the user to use this airgun properly and safely.

WARNING!

1. Each HATSAN JET airgun contains pressurized air and should only be dismantled by a competent gunsmith. Do not attempt to dismantle the airgun if the airgun is partially or fully charged, except for removal and replacement of the air cylinder (on JET I models only). Serious injury and/or damage may result if this instruction is ignored.
2. Never shoot the airgun when the air cylinder is removed or empty. This may damage your airgun. Never attempt to dismantle the air cylinder parts or air gauge when the air cylinder is fully or partially charged. Serious injury and/or damage may result if this instruction is ignored.
3. Don't use BBs with your airgun and use only factory manufactured, waisted, high-quality pellets.
4. The HATSAN JET airgun is designed specifically for use with **DRY COMPRESSED AIR**. NO OTHER GAS OR GAS COMBINATION IS TO BE USED.
5. The airgun may be filled from a diver's bottle, a suitable compressor, or by using a hand pump specifically made to fill pre-charged airguns. **MAXIMUM SAFE WORKING PRESSURE (SWP) : 250 BAR.**

I. GENERAL INSTRUCTION

The HATSAN JET series have front and rear sights. It is also possible to attach a scope or other optical aiming devices to the airgun using 11mm dovetail mounts.

Before using your new airgun check if it is fully charged and abide the below basic safety rules:

Basic Safety Rules:

1. Treat every airgun as if it is loaded.
2. Never point the airgun at anyone, or allow anyone to point an airgun at you, even if you know it is not loaded.
3. Always carry the airgun so that the direction of the muzzle is under control, even if you stumble.
4. Always be sure of your target and what lies behind it before firing your airgun.
5. Never leave a loaded airgun unattended.
6. Be alert to targets that tend to cause ricochets.
7. It is recommended that eye & ear protection is worn when charging the cylinder and when shooting.
8. Until you are actually ready to shoot, keep your finger off the trigger, and the safety latch in the "ON" position.

II. SPECIFICATIONS

	JET-I	JET-II
Barrel Length	200mm (7.9")	200mm (7.9")
Overall Length	380mm (15") Pistol 625-580mm (24.6"-22.8") Rifle	380mm (15") Pistol 625-580mm (24.6"-22.8") Rifle
Weight	0,9 kg (2 lbs) Pistol 1,34 kg (2.9 lbs) Rifle	1,1 kg (2.4 lbs) Pistol 1,54 kg (3.4 lbs) Rifle
Max. Fill Pressure	250 Bar	250 Bar

Caliber	Max Muzzle Velocity (*)	Energy	
		Joules	ft.lbs
4.5mm / .177cal	235m/s (810 fps)	20	10.3
5.5mm / .22cal	210m/s (700 fps)	27	15.6
6.35mm / .25cal	197m/s (650 fps)	30	16.5

** The above velocity rates may differ depending on the pellet weight & shape. The above velocity rates reflect the product's maximum velocity. Velocity rates are determined by the laws of the importing country. If there are muzzle energy/velocity restrictions in your country, then this product was produced in compliance with these related muzzle energy / velocity laws - resulting in a lower muzzle velocity.*

III. BASIC PARTS OF YOUR AIRGUN

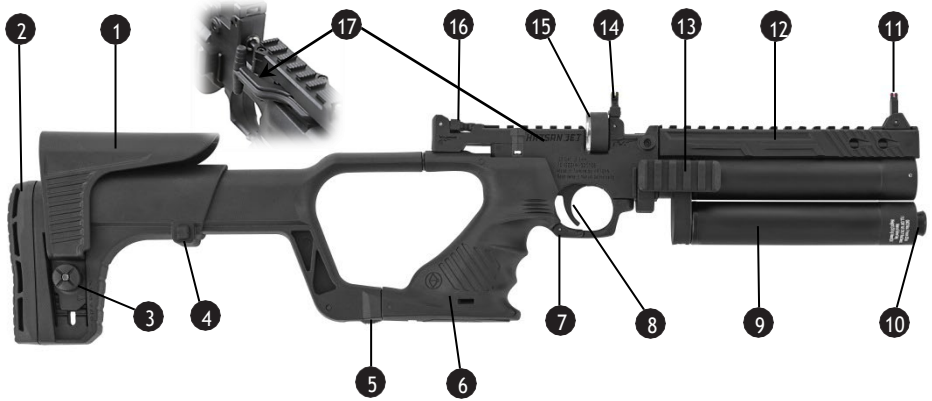

- 1. Cheek rest
- 2. Buttpad
- 3. Cheek rest adjustment button
- 4. Telescopic stock extension button
- 5. Release/attach button for telescopic stock

- 6. Grip
- 7. Safety latch
- 8. Trigger
- 9. Air cylinder
- 10. Air fill tip
- 11. Front sight

- 12. Shrouded barrel
- 13. Picatinny rail
- 14. Rear sight (For Rifle)
- 15. Magazine
- 16. Rear sight (For Pistol)
- 17. Charging lever

IV. MANUAL SAFETY

Safety ON

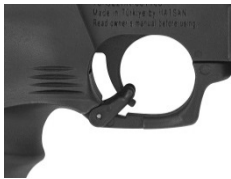

Pic. 1

Safety OFF



Pic. 2

Safety latch can be set to "ON" and "OFF" positions manually.

To set the safety to "ON", pull safety latch upward. In this position, the trigger can't be pulled, and the airgun can't be shot (Pic 1). To remove the safety to "OFF", push safety latch downward. In this position, the airgun is ready to shoot (Pic 2).

CAUTION: Until you are actually ready to shoot, keep the safety latch in the "ON" position (Pic. 1).

V. ADJUSTABLE TRIGGER

HATSAN JET's trigger travel and trigger load is externally adjustable. You can adjust the trigger with 1.5mm allen key, which supplied with your airgun. Turn the screw clockwise to decrease and counterclockwise to increase it.



Pic. 3

VI. SIGHT ADJUSTMENT

There are 2 folding rear sights and 1 front sight on your airgun. You can adjust the sights according to the rifle or pistol module.

For Use as a Rifle:

- Flip up the sight which has “rifle picture” at the bottom.
- If you shoot above the target, turn the height adjustment drum counterclockwise. (Pic. 4)
- If you shoot below the target, turn the height adjustment drum clockwise. (Pic. 4)



Sights position as a rifle

For Use as a Pistol:

- Flip up the sight which has “pistol picture” at the bottom.
- If you shoot above the target, turn the height adjustment drum counterclockwise. (Pic. 4)
- If you shoot below the target, turn the height adjustment drum clockwise. (Pic. 4)



Height adjustment drum

Pic 4



VI. OPERATING INSTRUCTIONS

Warning!

1. **Before filling the air cylinder make sure the safety is in the ON position, no pellets are loaded in the airgun, and/or the magazine is not mounted in the airgun. If the air cylinder is completely empty, fill air cylinder after cocking the airgun and keep the charging lever open at the rear.**
2. **Take all safety measures before filling the air cylinder. It is recommended for the user and bystanders to wear eye & ear protection when filling the air cylinder.**
3. **While filling in the air cylinder, the pressure must be monitored from the air gauge of the hand pump or scuba charging kit. Do not measure the air pressure by the air gauge on the airgun during filling process. Instead, reference the gauge on your fill device.**

Charging the Airgun:

- Pull the charging handle backwards until it stops and locks at the back. Set to the safety latch “On”. (Pic 5)
- Fit the female quick disconnect nozzle to the air line of the charging equipment, which must incorporate a pressure gauge. Ensure both female disconnect nozzle and airgun male fitting are clear from dirt and gently push the nozzle into the filler hole as in Pic. 5.
- Fill the air cylinder up to pressure quoted previously in this manual (**250 Bar**). Do not exceed the maximum fill pressure as this will reduce the muzzle velocity of the pellets and may damage internal components, which may cause danger to you and others around you. When using a diver’s bottle, refill the airgun slowly to prevent the heat created by the filling process from damaging the airgun’s components.
- Undo the bleeder valve on the hose before disconnecting the female fitting from the male fitting on the airgun.



JET I

Pic 5



JET II

Pic 5

Removable Air Cylinder (For HATSAN JET I):

*****THIS FEATURE IS NOT AVAILABLE FOR THE HATSAN JET II*****

The HATSAN JET I is equipped with a removable air cylinder. The cylinder can be removed while charged. First, be sure that the airgun is first not cocked or loaded. Slowly unscrew the cylinder. A small amount of air will escape after the cylinder has been unscrewed a few turns - this is normal. Finish unscrewing the cylinder to remove it. A spare cylinder that has already been charged can be installed, or the same cylinder can be re-installed.

Loading the Airgun and Shooting:

- The magazine is composed of a front side (black part) and a back side (transparent part). The magazine is designed to be allowed to fit only one way into the airgun.
- Hold the magazine with its black part up, over the transparent side. (Pic.6)



Pic. 6



- Spin the black part counter-clockwise to release the cover from the catch point. Then insert the pellet in backwards (skirt first) into the first location. Continue to turn the black part counter-clockwise until it stops. (Pic.7)

c. 7

- Spinning the in the same direction and holding the magazine in a vertical position continue placing the pellets until the all positions are filled. Once the magazine is full, spin the black side in the opposite direction and return the magazine to its initial position. (Pic. 8)

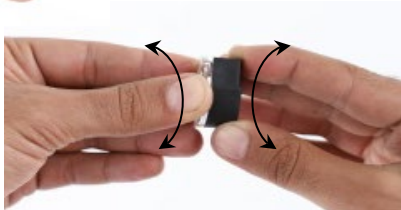

Pic. 8

cover

- With the transparent cover facing the butt of the airgun and charging handle fully to the rear, insert the magazine, pointed end first, from the right side of the airgun and push it inwards all the way in until it's fully in place. (Pic. 9 & 10)



Pic. 9



Pic. 10



Pic. 11

Shooting:

- Once you are ready to fire, pull the charging lever back and then move it all the way forward. (Pic.11)
- Aim at your intended target, disengage the safety and get ready to shoot
- Pull the trigger slowly, the airgun will fire.
- To reload the airgun, pull the charging lever back and move it all the way forward again.

VII. MAINTENANCE

Warning!

Never attempt to disassemble this airgun. Never fire when the air cylinder is empty or removed. Failure to obey this instruction could result in damage to your airgun.

- Never lubricate inside the barrel as this will affect the accuracy & grouping of the airgun in a negative manner. Occasionally, apply proper mineral based oils sparingly to the following parts:

- The trigger mechanism
- The charging lever sliding surface

DO NOT OVER-LUBRICATE THE AIRGUN!

- It is recommended to clean the barrel with a cleaning rod every 500 shots. Never lubricate inside the barrel.
- Before you begin oiling or cleaning your airgun, always check to make sure it is unloaded.
- Always be sure your airgun barrel is clean and not blocked.
- After cleaning ensure that no cleaning patch or other obstruction remains in the barrel.
- Annually, take your airgun to a gunsmith even if it seems to be working well, since some issues in your airgun may not be apparent from external examination.
- Take your airgun to a gunsmith if water, sand, etc. enters the internal mechanism of the airgun, for complete cleaning.
- Dangerous conditions may occur if you do not keep your airgun clean and working properly.

Safety Measures & Warnings

- This airgun will shoot if cocked, loaded, safety disengaged, and trigger pulled.
- **Airguns are not toys.** Never let young children use an airgun unsupervised. Adult supervision is strictly required during use. Misuse or careless use may cause serious injury or death.
- Learn how your airgun operates and safe gun handling procedures before loading and using it.
- **ALWAYS USE EYE & HEARING PROTECTION AND MAKE BYSTANDERS USE THE SAME.** Failure to do so may result in eye injuries and permanent hearing loss.
- Do not point at anything you do not intend to shoot, even if the airgun is unloaded. Always keep the airgun pointed in a safe direction.
- Never pull an airgun toward you by the muzzle.
- Always aim at a safe target, taking care that it does not conceal any other object, know what is behind your target.
- Before you fire, consider where the pellet will travel should you miss your intended target, thus ensuring no damage or harm could result.
- Be sure of your target before you pull the trigger. Never shoot at sounds.
- When shooting, always have a safe shooting range, that is - have a safe area for shooting, a safe distance between you and the target, and a safe backstop to trap the pellets and hold the target.
- Do not fire at a target, which allows ricochets or deflections.
- Do not fire into or at water.
- Do not fire at or near power lines or insulators. Be especially careful in wooded areas where power lines may not be as visible.

- Do not load the airgun until you are ready to shoot.
- Always keep your fingers away from the trigger & muzzle during cocking and handling.
- Do not walk, run, or jump when carrying a loaded or cocked airgun. A loaded or a cocked airgun should never be carried inside a vehicle, house, camp, or public place.
- Never climb a tree or fence or jump a ditch with a loaded airgun. In such a case, first unload it and hand the airgun to a friend or place it on the ground on the other side of the obstacle before crossing yourself.
- When transporting the airgun, keep it unloaded and **'on safe'**.
- Always keep the airgun **'on safe'** until you are ready to shoot even if the airgun is unloaded.
- Always store the airgun unloaded and **'on safe'**.
- Always check to see if the airgun is **'on safe'** and unloaded when getting it from another person or from storage.
- **ALWAYS KEEP THE AIRGUN AND/OR PELLETS OUT OF THE REACH OF CHILDREN.**
- Keep the airgun and pellets in separate places, better if under lock and key.
- **Do not attempt to disassemble or tamper with your airgun.** Use a competent gunsmith. Many airguns contain powerful springs which can cause serious injury if released in an uncontrolled manner.
- Always handle and treat your airgun as though it were loaded.
- **Improper use or handling of airguns is not the responsibility of the manufacturer or distributor, under any circumstances. The user is responsible for any harm, which may be caused.**
- Think first, fire second.
- Don't rely on any mechanical safety. Half safe is not safe.
- Be safe not sorry.
- Respect other's property.
- Airguns should never be used under the influences of alcohol or drugs.



[instagram.com/hatsanarms](https://www.instagram.com/hatsanarms)



[facebook.com/hatsan.com.tr](https://www.facebook.com/hatsan.com.tr)



[youtube.com/hatsanarms](https://www.youtube.com/hatsanarms)



Serious. Solid. Impact.

HATSA

Silah Makine Kalıp San. ve Tic. A.Ş.

Kemalpaşa O.S.B. Mahallesi
Ansızca Sanayi Sitesi No: 303 İç Kapı No:1
35170 Kemalpaşa - İZMİR
Tel: 0 (232) 878 91 00 • Faks: 0 (232) 878 91 02

www.hatsan.com.tr

info@hatsan.com.tr